

JOINT
PUBLIC NOTICE

CHARLESTON DISTRICT, CORPS OF ENGINEERS
69A Hagood Avenue
Charleston, South Carolina 29403
and
THE S.C. DEPARTMENT OF HEALTH AND ENVIRONMENTAL CONTROL
Office of Ocean and Coastal Resource Management
1362 McMillan Avenue, Suite 400
Charleston, South Carolina 29405

REGULATORY DIVISION
Refer to: P/N SAC-2017-01482

January 4, 2019

Pursuant to Section 103 of the Marine Protection, Research, and Sanctuaries Act (33 U.S.C. 1413), and the South Carolina Coastal Zone Management Act (48-39-10 et.seq.), an application has been submitted to the Department of the Army and the S.C. Department of Health and Environmental Control by

MR. WALTER LAGARENNE
SOUTH CAROLINA PORTS AUTHORITY
POST OFFICE BOX 22287
CHARLESTON, SOUTH CAROLINA 29413

for a permit to transport dredged material from the Hugh K. Leatherman, Sr. Terminal (HLT) for the purpose of ocean disposal in the

CHARLESTON OCEAN DREDGED MATERIAL DISPOSAL SITE

at a location approximately nine nautical miles southeast of Charleston, South Carolina and identified as "Dump Site (dredged material)" on NOAA Nautical Chart 11521, Charleston Harbor and Approaches (Latitude: 32.6047°N, Longitude: 79.7277°W, Lat: 32.6274°N, Long: 79.7763°W, Lat: 32.6657°N, Long: 79.7511°W, Lat: 32.6430°N, Long: 79.7025°W).

In order to give all interested parties an opportunity to express their views

NOTICE

is hereby given that written statements regarding the proposed work will be received by the **Corps** until

15 Days from the Date of this Notice,

and **SCDHEC** will receive written statements regarding the proposed work until

30 Days from the Date of this Notice

from those interested in the activity and whose interests may be affected by the proposed work.

Pursuant to Section 10 of the Rivers and Harbors Act of 1899 (33 U.S.C. 403) and Sections 401 and 404 of the Clean Water Act (33 U.S.C. 1344), Department of the Army (DA) permit number SAC-2017-01482 authorizes the South Carolina Ports Authority (SCPA) to conduct approximately 2.34 million cubic yards of new work dredging and 328,000 cubic yards of annual maintenance dredging associated with the berth and access channel at the Hugh K. Leatherman, Sr. Terminal (HLT). The authorized depth of the berth is -45 feet Mean Lower Low Water + 2 feet of advanced maintenance + 2 feet of extreme low tidal variation + 2 feet of allowable overdepth. The total depth of the berth is 2 feet deeper than the access channel (and the adjacent Federal navigation channel) so container ships can rise and fall with the tide while they are being loaded and unloaded at HLT.

The existing DA permit authorizes the SCPA to hydraulically pump dredged material from HLT to an existing dredged material containment area (DMCA), or to place the dredged material in scows before hydraulically pumping it into one of the DMCA's on Clouter Island, Daniel Island, or Drum Island. This 10-year new work and maintenance dredging permit is scheduled to expire on September 30, 2028. In accordance with Section 103 of the Marine Protection, Research, and Sanctuaries Act (MPRSA), the SCPA has requested to modify this permit so the dredged material can also be transported to the Charleston Ocean Dredged Material Disposal Site (ODMDS) for the purpose of ocean disposal.

The proposed modification would not alter the footprint of the previously authorized berth or access channel at HLT (approximately 77.8 acres). The SCPA would use the same dredging methods, a hydraulic cutterhead or a mechanical dredge, to dredge the berth and access channel and to place the dredged material into scows. The only difference is that the SCPA would transport the dredged material from HLT to the Charleston ODMDS (rather than hydraulically pumping the dredged material into an existing DMCA). Drawing sheet 7 of 7 identifies the state plane coordinates for the 9.8-square mile boundary of the ODMDS and the 5.1-square mile disposal zone that is located inside the ODMDS.

The Charleston ODMDS was designated by the U.S. Environmental Protection Agency (EPA) for the long-term placement of dredged material associated with the Charleston Harbor Federal navigation channel and other dredging projects near Charleston, South Carolina. Over the past 20 years approximately 22 million cubic yards of new work material and 1 million cubic yards per year of maintenance material has been placed in the ODMDS (a total of more than 42 million cubic yards). Since the berth and access channel at HLT are located adjacent to the Federal navigation channel, the SCPA believes there may be opportunities for contractors to use the same dredging equipment to conduct work associated with both projects.

The SCPA recently conducted sediment testing to determine whether new work and maintenance material from HLT is considered suitable for placement in the Charleston ODMDS. This data is currently being evaluated by the Corps, EPA, and the other regulatory and resource agencies. Please note the SCPA has also conducted sediment testing for the Wando Welch Terminal (WWT), Columbus Street Terminal (CST), and Union Pier Terminal (UPT). Since each port facility has its own DA permit, the SCPA has submitted separate requests to modify the existing dredging permits or to obtain new DA permits for the berths at WWT, CST, and UPT.

The proposed work is limited to modifying the existing DA permit so new work and maintenance material from the berth and access channel can be transported to the Charleston ODMDS. If authorized, dredged material that is determined to be suitable for ocean disposal may be transported to the Charleston ODMDS in accordance with the approved Site Management and Monitoring Plan dated June 2016. The SCPA has not proposed compensatory mitigation to offset

additional impacts associated with transporting dredged material from HLT to the Charleston ODMDS. According to the applicant, the purpose of the proposed project is to improve dredging efficiency and cost-effectiveness and to improve management of the long-term capacity at existing, upland DMCA's.

NOTE: This public notice and associated plans are available on the Corps' website at: <http://www.sac.usace.army.mil/Missions/Regulatory/PublicNotices> .

The District Engineer has concluded that the discharges associated with this project, both direct and indirect, should be reviewed by the South Carolina Department of Health and Environmental Control in accordance with provisions of Section 401 of the Clean Water Act. As such, this notice constitutes a request, on behalf of the applicant, for certification that this project will comply with applicable effluent limitations and water quality standards. The work shown on this application must also be certified as consistent with applicable provisions of the Coastal Zone Management Program (15 CFR 930). State review, permitting and certification is conducted by the S. C. Department of Health and Environmental Control. The District Engineer will not process this application to a conclusion until such certifications are received. The applicant is hereby advised that supplemental information may be required by the State to facilitate the review.

This notice initiates the Essential Fish Habitat (EFH) consultation requirements of the Magnuson-Stevens Fishery Conservation and Management Act. Implementation of the proposed modification would result in no additional impacts to estuarine substrates and emergent wetlands utilized by various life stages of species comprising the shrimp, and snapper-grouper management complexes. The District Engineer's initial determination is that the proposed action (i.e., the transportation of dredged material to an EPA designated ODMDS) would not have a substantial individual or cumulative adverse impact on EFH or fisheries managed by the South Atlantic Fishery Management Council and the National Marine Fisheries Service (NMFS). The District Engineer's final determination relative to project impacts and the need for mitigation measures is subject to review by and coordination with the NMFS.

Pursuant to Section 7 of the Endangered Species Act of 1973 (as amended), the Corps has reviewed the project area, examined all information provided by the applicant, and the District Engineer has determined, based on the most recently available information that the transportation of dredged material from HLT to the Charleston ODMDS would have no effect on the Federally endangered shortnose sturgeon (*Acipenser brevirostrum*), Atlantic sturgeon (*Acipenser oxyrinchus*), North Atlantic right whale (*Eubalaena glacialis*), designated critical habitat for the Atlantic sturgeon, or designated critical habitat for the North Atlantic right whale, and may affect, but is not likely to adversely affect the Federally endangered West Indian manatee (*Trichechus manatus*), which is present in the vicinity of the project area. This public notice serves as a request for written concurrence from the U.S. Fish and Wildlife Service and/or the National Marine Fisheries Service on this determination.

Pursuant to Section 106 of the National Historic Preservation Act (NHPA), this public notice also constitutes a request to Indian Tribes to notify the District Engineer of any historic properties of religious and cultural significance to them that may be affected by the proposed undertaking.

In accordance with Section 106 of the NHPA, the District Engineer has consulted South Carolina ArchSite (GIS), for the presence or absence of historic properties (as defined in 36 C.F.R. 800.16)(j)(1)), and has initially determined that no historic properties are present;

therefore, there will be no effect on historic properties. To ensure that other historic properties that the District Engineer is not aware of are not overlooked, this public notice also serves as a request to the State Historic Preservation Office and any other interested parties to provide any information they may have with regard to historic properties. This public notice serves as a request for concurrence within 30 days from the SHPO (and/or Tribal Historic Preservation Officer).

The District Engineer's final eligibility and effect determination will be based upon coordination with the SHPO and/or THPO, as appropriate and required and with full consideration given to the proposed undertaking's potential direct and indirect effects on historic properties within the Corps-identified permit area.

Any person may request, in writing, within the comment period specified in this notice, that a public hearing be held to consider this application. Requests for a public hearing shall state, with particularity, the reasons for holding a public hearing.

The decision whether to issue a permit will be based on an evaluation of the probable impact including cumulative impacts of the activity on the public interest and will include application of the guidelines promulgated by the Administrator, Environmental Protection Agency (EPA), under authority of Section 404(b) of the Clean Water Act. That decision will reflect the national concern for both protection and utilization of important resources. The benefit which reasonably may be expected to accrue from the project must be balanced against its reasonably foreseeable detriments. All factors which may be relevant to the project will be considered including the cumulative effects thereof; among those are conservation, economics, aesthetics, general environmental concerns, wetlands, historic properties, fish and wildlife values, flood hazards, flood plain values, land use, navigation, shoreline erosion and accretion, recreation, water supply and conservation, water quality, energy needs, safety, food and fiber production and, in general, the needs and welfare of the people. A permit will be granted unless the District Engineer determines that it would be contrary to the public interest. In cases of conflicting property rights, the Corps cannot undertake to adjudicate rival claims.

The Corps is soliciting comments from the public; Federal, state, and local agencies and officials; Indian Tribes; and other interested parties in order to consider and evaluate the impacts of this activity. Any comments received will be considered by the Corps to determine whether to issue, modify, condition or deny a permit for this project. To make this decision, comments are used to assess impacts on endangered species, historic properties, water quality, general environmental effects, and the other public interest factors listed above. Comments are used in the preparation of an Environmental Assessment pursuant to the National Environmental Policy Act. Comments are also used to determine the need for a public hearing and to determine the overall public interest of the activity. **Please submit comments in writing, identifying the project of interest by public notice number, to the following address:**

**U.S. Army Corps of Engineers
ATTN: REGULATORY DIVISION
69A Hagood Avenue
Charleston, South Carolina 29403**

If there are any questions concerning this public notice, please contact Nat Ball, Project Manager, at (843) 329-8047 or toll free at 1-866-329-8187.

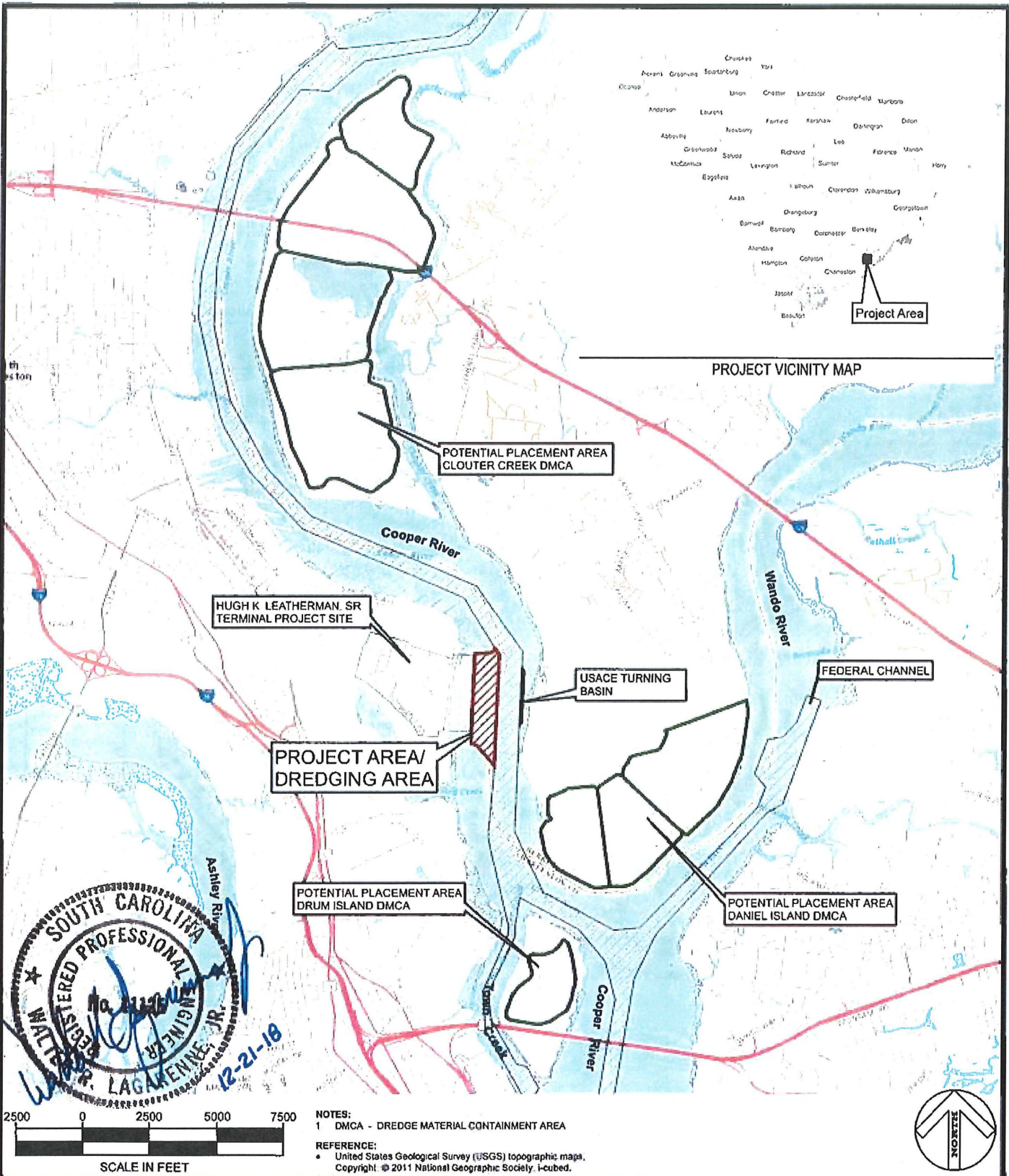

REGISTERED PROFESSIONAL ENGINEER
 SOUTH CAROLINA
 No. 31125
 WALTER R. LAGAKENNE, JR.
 12-21-18

2500 0 2500 5000 7500
 SCALE IN FEET

NOTES:
 1 DMCA - DREDGE MATERIAL CONTAINMENT AREA
REFERENCE:
 • United States Geological Survey (USGS) topographic maps.
 Copyright © 2011 National Geographic Society, Inc.

VERTICAL DATUM: MLLW (FEET)
 0 FEET (MLLW) = -3.18 FEET (NAVD88)
COORDINATE SYSTEM: S.C. STATE PLANE
 (NAD83 in US FEET)

P/N # -

PROJECT LOCATION MAP
SOUTH CAROLINA PORTS AUTHORITY
 176 CONCORD STREET
 P.O. BOX 22287
 CHARLESTON, S.C. 29413-2287

PROPOSED: HUGH K. LEATHERMAN, SR.
 TERMINAL BERTH AND ACCESS DREDGING
 AND REVETMENT MODIFICATION
IN: NORTH CHARLESTON
AT: CHARLESTON COUNTY, SOUTH CAROLINA
APPLICATION BY: SC PORTS AUTHORITY
SHEET: 1 OF 10 **DATE:** December 20, 2018

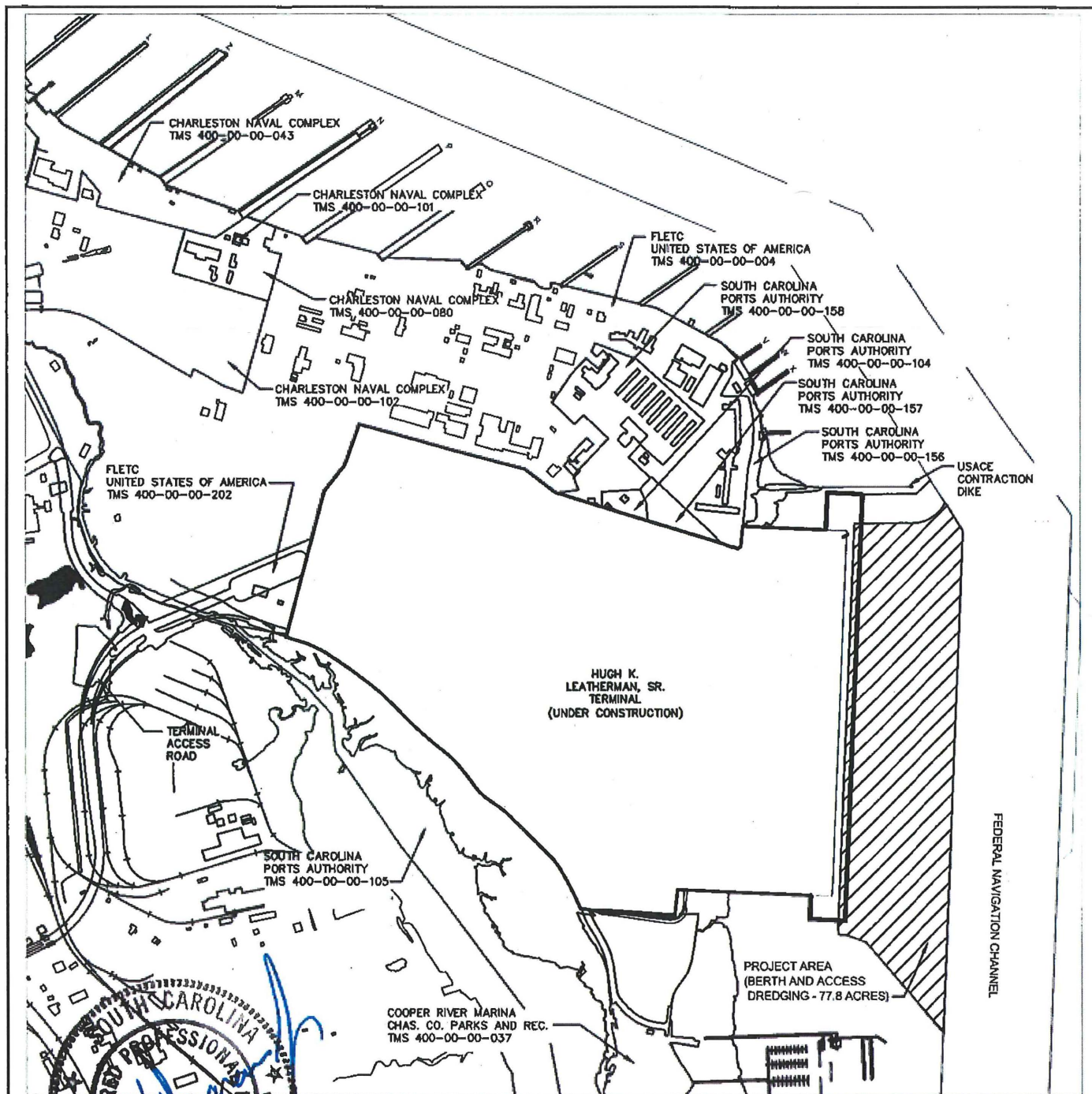

WALTER R. LAGARENNE, JR.

 No. 1128

 12-21-18



NOTES:
 1 PARCEL DATA HAS BEEN DIGITIZED FROM CHARLESTON COUNTY RMS
REFERENCE:
 • SITE PLAN FROM SOUTH CAROLINA PORTS AUTHORITY NEW CONTAINER TERMINAL PLAN JANUARY 22 2003



VERTICAL DATUM: MLLW (FEET)
 0 FEET (MLLW) = -3.18 FEET (NAVD88)
 COORDINATE SYSTEM: S.C. STATE PLANE
 (NAD83 in US FEET)

P/N # -

ADJACENT PROPERTY OWNERS
SOUTH CAROLINA PORTS AUTHORITY
 176 CONCORD STREET
 P.O. BOX 22287
 CHARLESTON, S.C. 29413-2287

PROPOSED: HUGH K. LEATHERMAN, SR.
 TERMINAL BERTH AND ACCESS DREDGING
 AND REVETMENT MODIFICATION
IN: NORTH CHARLESTON
AT: CHARLESTON COUNTY, SOUTH CAROLINA
APPLICATION BY: SC PORTS AUTHORITY
SHEET: 2 OF 10 DATE: December 20, 2018

 PREVIOUSLY AUTHORIZED BERTH AND ACCESS AREA

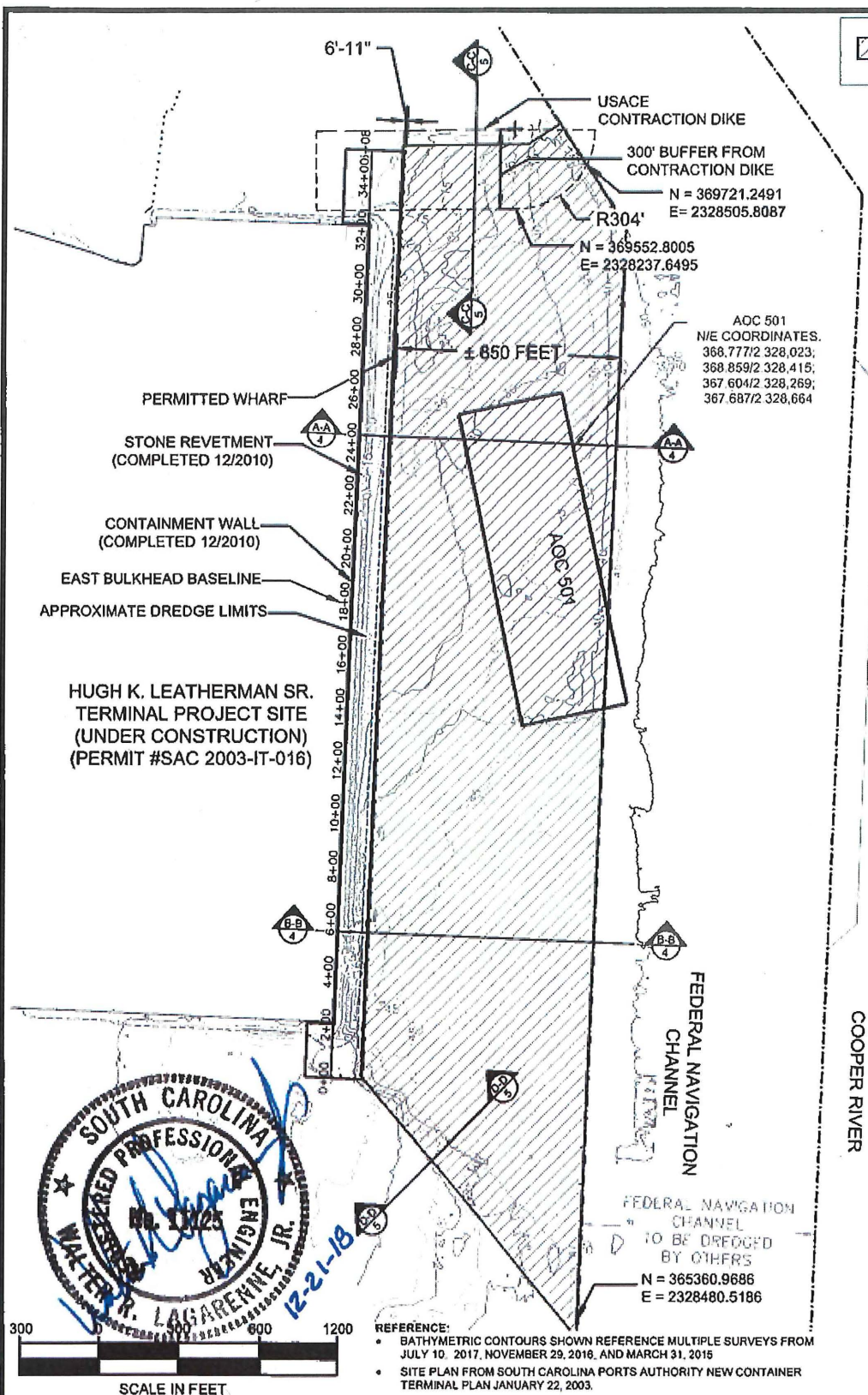

PERMITTED WHARF
 STONE REVETMENT
 (COMPLETED 12/2010)
 CONTAINMENT WALL
 (COMPLETED 12/2010)
 EAST BULKHEAD BASELINE
 APPROXIMATE DREDGE LIMITS

HUGH K. LEATHERMAN SR.
 TERMINAL PROJECT SITE
 (UNDER CONSTRUCTION)
 (PERMIT #SAC 2003-IT-016)

USACE
 CONTRACTION DIKE
 300' BUFFER FROM
 CONTRACTION DIKE
 N = 369721.2491
 E = 2328505.8087
 R304'
 N = 369552.8005
 E = 2328237.6495

AOC 501
 N/E COORDINATES:
 368.777/2 328,023;
 368.859/2 328,415;
 367.604/2 328,269;
 367.687/2 328,664

FEDERAL NAVIGATION
 CHANNEL
 TO BE DREDGED
 BY OTHERS
 N = 365360.9686
 E = 2328480.5186

REFERENCE:
 • BATHYMETRIC CONTOURS SHOWN REFERENCE MULTIPLE SURVEYS FROM JULY 10, 2017, NOVEMBER 29, 2010, AND MARCH 31, 2015
 • SITE PLAN FROM SOUTH CAROLINA PORTS AUTHORITY NEW CONTAINER TERMINAL PLAN JANUARY 22, 2003.

300 600 1200
 SCALE IN FEET

VERTICAL DATUM: MLLW (FEET)
 0 FEET (MLLW) = -3.18 FEET (NAVD88)
 COORDINATE SYSTEM: S.C. STATE PLANE
 (NAD83 in US FEET)

P/N # -

**EXISTING CONDITIONS
 PLAN VIEW**
SOUTH CAROLINA PORTS AUTHORITY
 176 CONCORD STREET
 P.O. BOX 22287
 CHARLESTON, S.C. 29413-2287

**PROPOSED: HUGH K. LEATHERMAN, SR.
 TERMINAL BERTH AND ACCESS DREDGING
 AND REVETMENT MODIFICATION**
 IN: NORTH CHARLESTON
 AT: CHARLESTON COUNTY, SOUTH CAROLINA
 APPLICATION BY: SC PORTS AUTHORITY
 SHEET: 3 OF 10 DATE: December 20, 2018

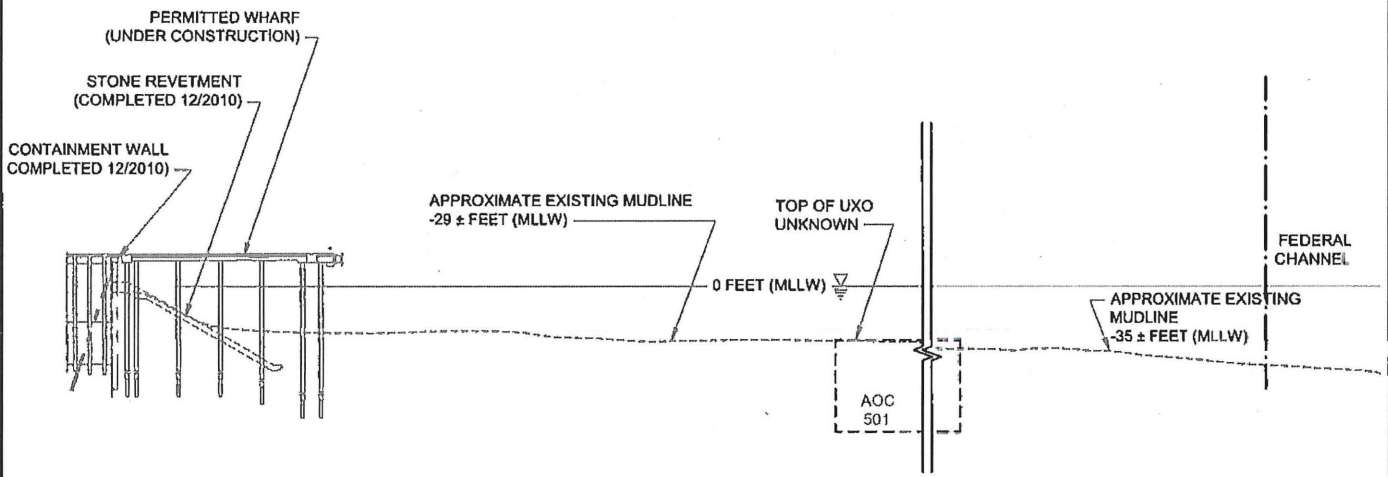

A-A SECTION - NORTH WHARF STA 24+30
3

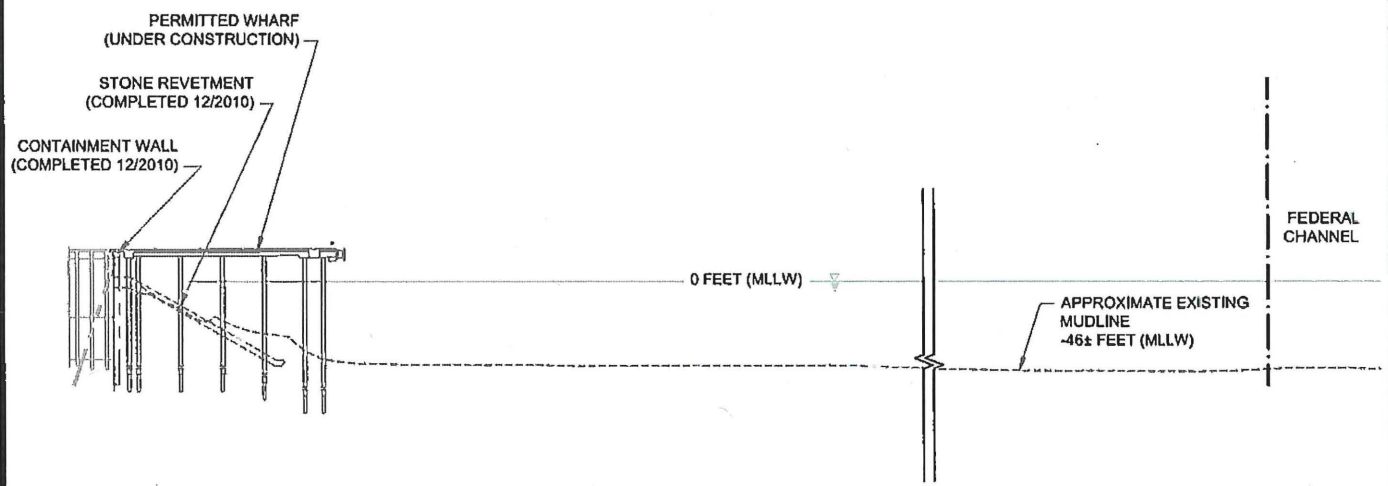

B-B SECTION - SOUTH WHARF STA 5+55
3

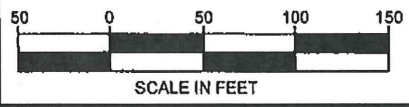

- REFERENCE:
- BATHYMETRIC CONTOURS SHOWN REFERENCE MULTIPLE SURVEYS FROM JULY 10, 2017, NOVEMBER 29, 2018, AND MARCH 31, 2015.
 - SITE PLAN FROM SOUTH CAROLINA PORTS AUTHORITY NEW CONTAINER TERMINAL PLAN JANUARY 22, 2003

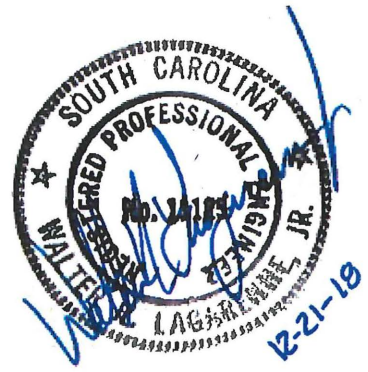

VERTICAL DATUM: MLLW (FEET)
0 FEET (MLLW) = -3.18 FEET (NAVD88)
COORDINATE SYSTEM: S.C. STATE PLANE
(NAD83 in US FEET)

P/N # -

**EXISTING CONDITIONS
PROFILE VIEW**

SOUTH CAROLINA PORTS AUTHORITY
176 CONCORD STREET
P.O. BOX 22287
CHARLESTON, S.C. 29413-2287

PROPOSED: HUGH K. LEATHERMAN, SR.
TERMINAL BERTH AND ACCESS DREDGING
AND REVETMENT MODIFICATION

IN: NORTH CHARLESTON
AT: CHARLESTON COUNTY, SOUTH CAROLINA
APPLICATION BY: SC PORTS AUTHORITY
SHEET: 4 OF 10 DATE: December 20, 2018

USACE CONTRACTION DIKE

0 FEET (MLLW)

APPROXIMATE EXISTING MUCLINE
-18 ± FEET (MLLW)

C-C SECTION - NORTH TRANSITION
3

0 FEET (MLLW)

APPROXIMATE EXISTING MUCLINE
-49± FEET (MLLW)

D-D SECTION - SOUTH TRANSITION
3

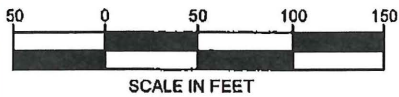
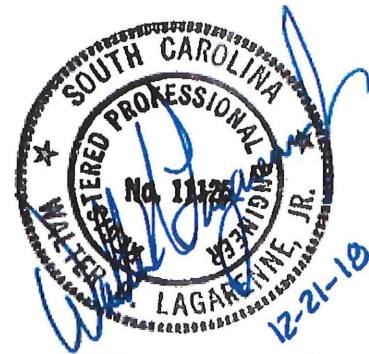

- REFERENCE:
- BATHYMETRIC CONTOURS SHOWN REFERENCE MULTIPLE SURVEYS FROM JULY 10, 2017, NOVEMBER 29, 2016, AND MARCH 31, 2015
 - SITE PLAN FROM SOUTH CAROLINA PORTS AUTHORITY NEW CONTAINER TERMINAL PLAN JANUARY 22, 2003

VERTICAL DATUM: MLLW (FEET)
0 FEET (MLLW) = -3.18 FEET (NAVD88)
COORDINATE SYSTEM: S.C. STATE PLANE
(NAD83 in US FEET)

P/N # -

**EXISTING CONDITIONS
PROFILE VIEW**
SOUTH CAROLINA PORTS AUTHORITY
176 CONCORD STREET
P.O. BOX 22287
CHARLESTON, S.C. 29413-2287

PROPOSED: HUGH K. LEATHERMAN, SR.
TERMINAL BERTH AND ACCESS DREDGING
AND REVETMENT MODIFICATION
IN: NORTH CHARLESTON
AT: CHARLESTON COUNTY, SOUTH CAROLINA
APPLICATION BY: SC PORTS AUTHORITY
SHEET: 5 OF 10 DATE: December 20, 2018

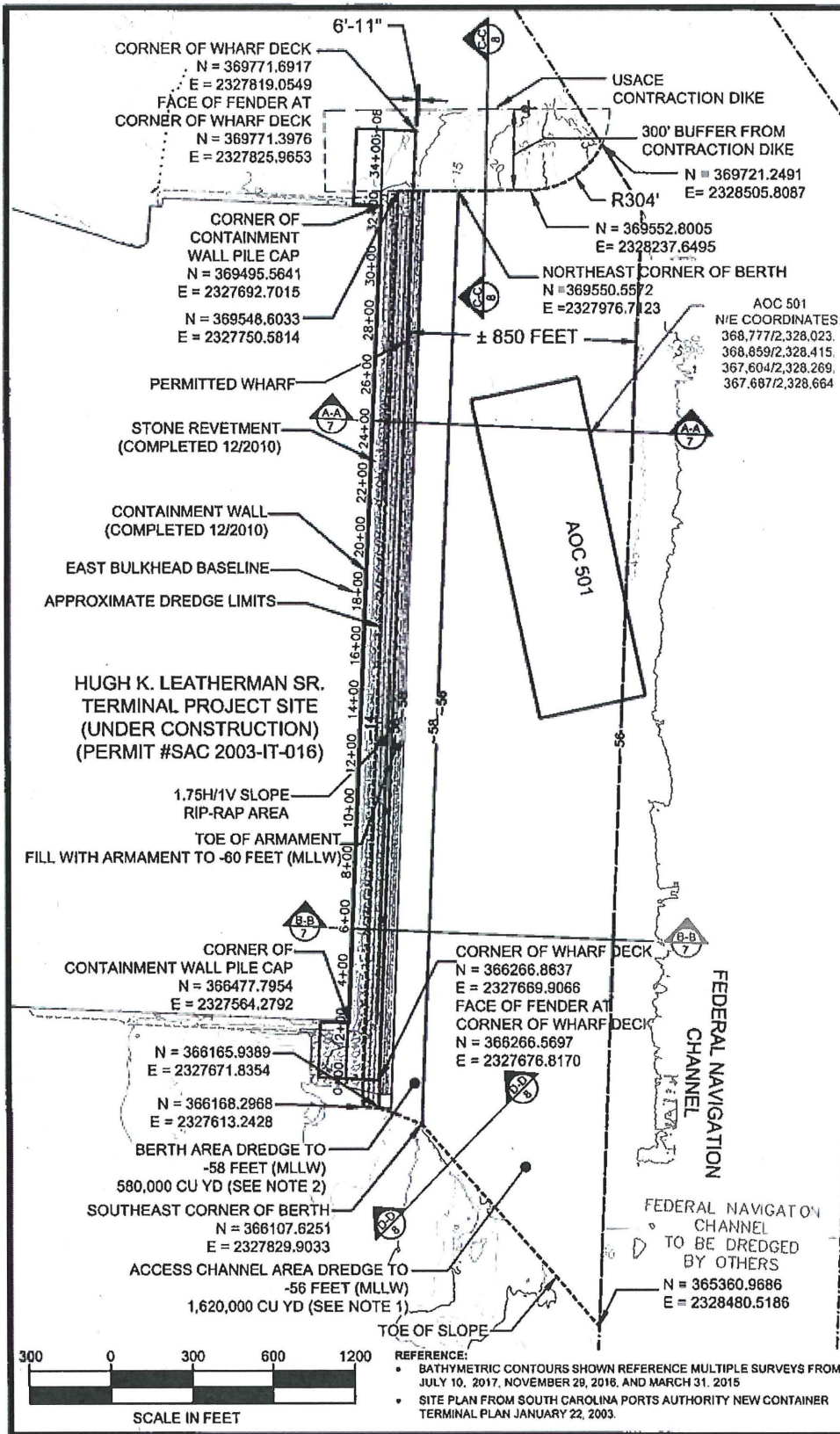

- DREDGING FOOTPRINT: 77.8 AC
- PROPOSED DREDGE VOLUME
Cut: -2,340,000 CU YD
Cut: -1,410,000 ABOVE -49 FEET MLLW
Cut: -930,000 BELOW -49 FEET MLLW
- PROPOSED ARMOR STONE AREA: 10 AC
PROPOSED ARMOR STONE VOLUME
ARMOR STONE LAYER: ~100,000 CU YD
BEDDING STONE LAYER: ~30,000 CU YD

- NOTES:**
1. ACCESS AREA DREDGE DEPTH ENTAILS DREDGING TO EL. -52 FEET MLLW, PLUS 2 FEET ADVANCED MAINTENANCE DREDGING, PLUS 2 FEET ALLOWABLE OVERDREDGE.
 2. BERTH AREA DREDGE DEPTH ENTAILS DREDGING TO EL. -52 FEET MLLW, PLUS 2 FEET ADVANCED MAINTENANCE DREDGING, PLUS 2 FEET EXTREME LOW TIDAL VARIATION, PLUS 2 FEET ALLOWABLE OVERDREDGE.

FLOOD
↑
COOPER RIVER
↓
EBB

FEDERAL NAVIGATION CHANNEL
TO BE DREDGED BY OTHERS

N = 365360.9686
E = 2328480.5186

12-21-18

REFERENCE:

- BATHYMETRIC CONTOURS SHOWN REFERENCE MULTIPLE SURVEYS FROM JULY 10, 2017, NOVEMBER 29, 2016, AND MARCH 31, 2015
- SITE PLAN FROM SOUTH CAROLINA PORTS AUTHORITY NEW CONTAINER TERMINAL PLAN JANUARY 22, 2003.

VERTICAL DATUM: MLLW (FEET)
0 FEET (MLLW) = -3.18 FEET (NAVD88)
COORDINATE SYSTEM: S.C. STATE PLANE
(NAD83 in US FEET)

P/N # -

**PROPOSED CONDITIONS
PLAN VIEW**

SOUTH CAROLINA PORTS AUTHORITY
176 CONCORD STREET
P.O. BOX 22287
CHARLESTON, S.C. 29413-2287

PROPOSED: HUGH K. LEATHERMAN, SR.
TERMINAL BERTH AND ACCESS DREDGING
AND REVETMENT MODIFICATION

IN: NORTH CHARLESTON
AT: CHARLESTON COUNTY, SOUTH CAROLINA
APPLICATION BY: SC PORTS AUTHORITY
SHEET: 6 OF 10 **DATE:** December 20, 2018

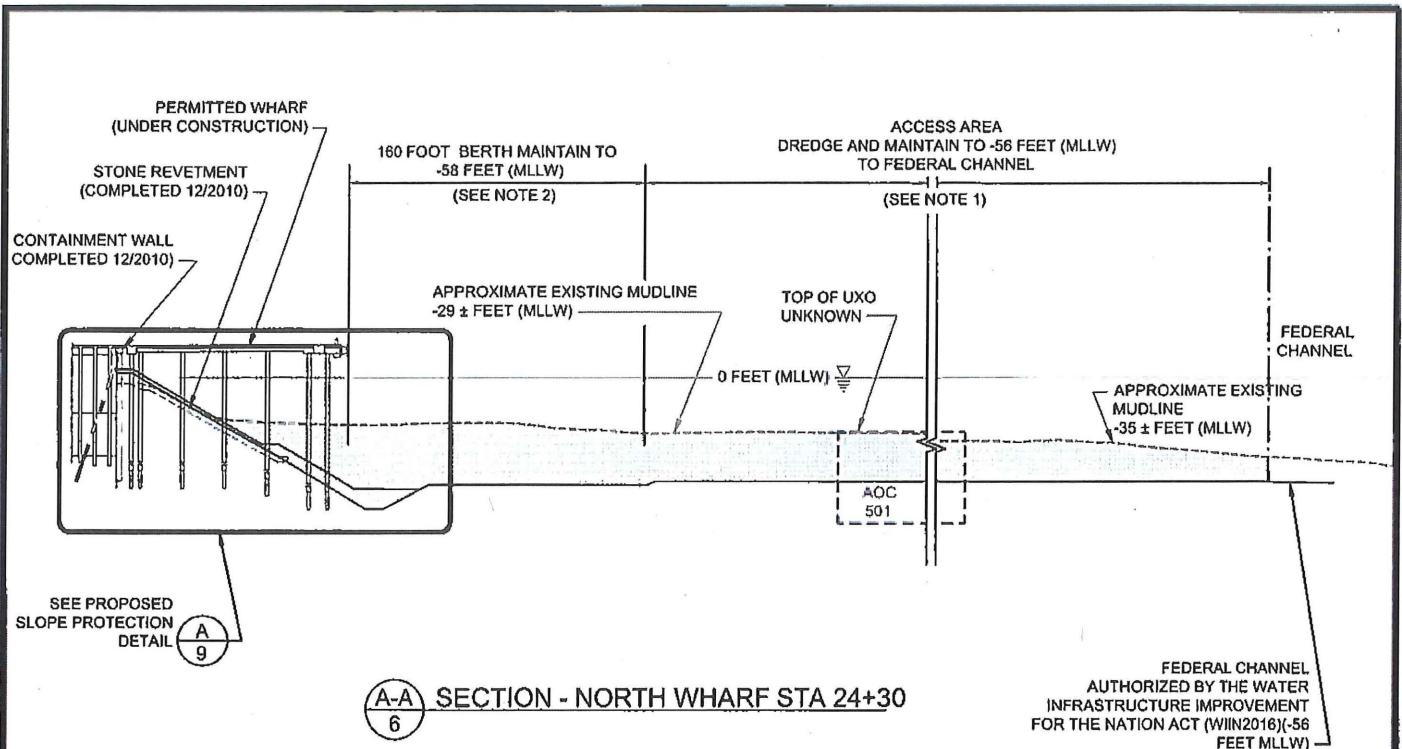

A-A SECTION - NORTH WHARF STA 24+30
6

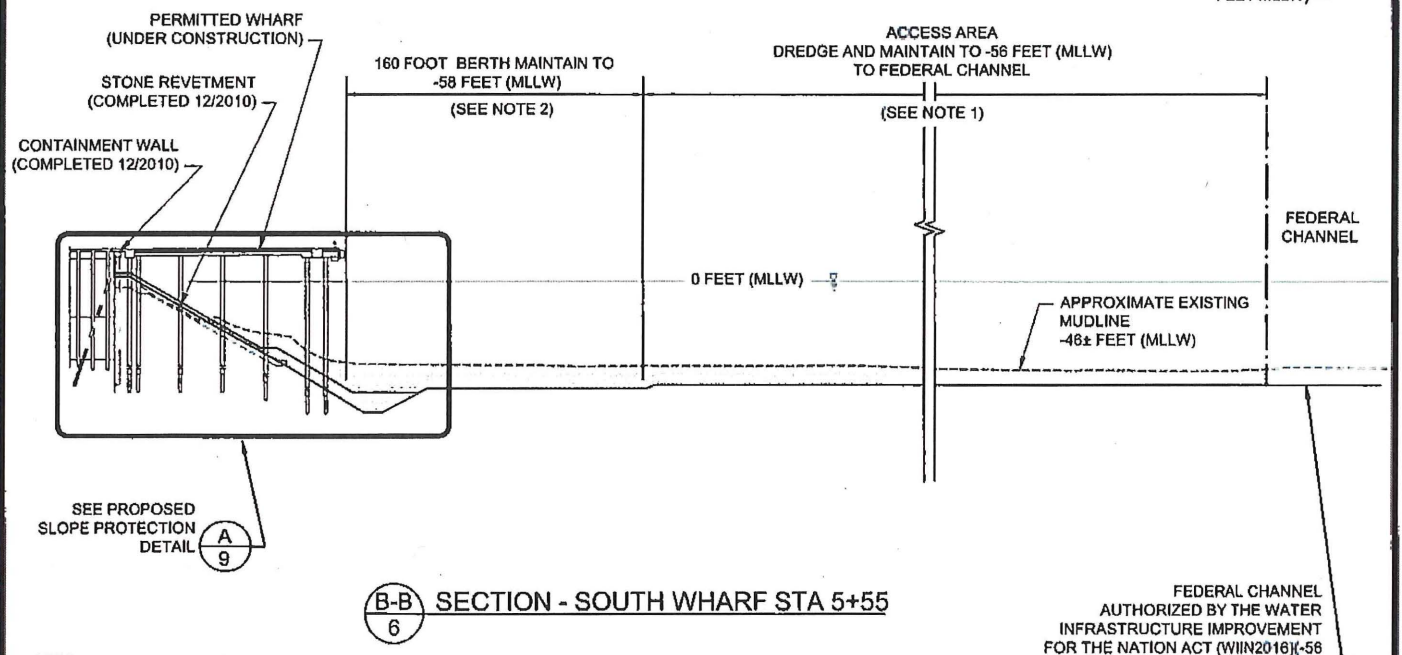

B-B SECTION - SOUTH WHARF STA 5+55
6

NOTES:

1. ACCESS AREA DREDGE DEPTH ENTAILS DREDGING TO EL. -52 FEET MLLW, PLUS 2 FEET ADVANCED MAINTENANCE DREDGING, PLUS 2 FEET ALLOWABLE OVERDREDGE.
2. BERTH AREA DREDGE DEPTH ENTAILS DREDGING TO EL. -52 FEET MLLW, PLUS 2 FEET ADVANCED MAINTENANCE DREDGING, PLUS 2 FEET EXTREME LOW TIDAL VARIATION, PLUS 2 FEET ALLOWABLE OVERDREDGE.

REFERENCE:
 • BATHYMETRIC CONTOURS SHOWN REFERENCE MULTIPLE SURVEYS FROM JULY 10, 2017, NOVEMBER 29, 2016, AND MARCH 31, 2015.
 • SITE PLAN FROM SOUTH CAROLINA PORTS AUTHORITY NEW CONTAINER TERMINAL PLAN JANUARY 22, 2003.

PROPOSED DREDGE AREA
 PROPOSED ARMAMENT (RIP-RAP) AREA



VERT. DATUM: MLLW
 0 FEET = 3.18 FEET (1088)
 COORD. SYSTEM: STATE PLANE
 IN US FEET

P/N # -

**PROPOSED CONDITIONS
 PROFILE VIEW**
SOUTH CAROLINA PORTS AUTHORITY
 176 CONCORD STREET
 P.O. BOX 22287
 CHARLESTON, S.C. 29413-2287

PROPOSED: HUGH K. LEATHERMAN, SR.
 TERMINAL BERTH AND ACCESS DREDGING
 AND REVETMENT MODIFICATION
 IN: NORTH CHARLESTON
 AT: CHARLESTON COUNTY, SOUTH CAROLINA
 APPLICATION BY: SC PORTS AUTHORITY
 SHEET: 7 OF 10 DATE: December 20, 2018

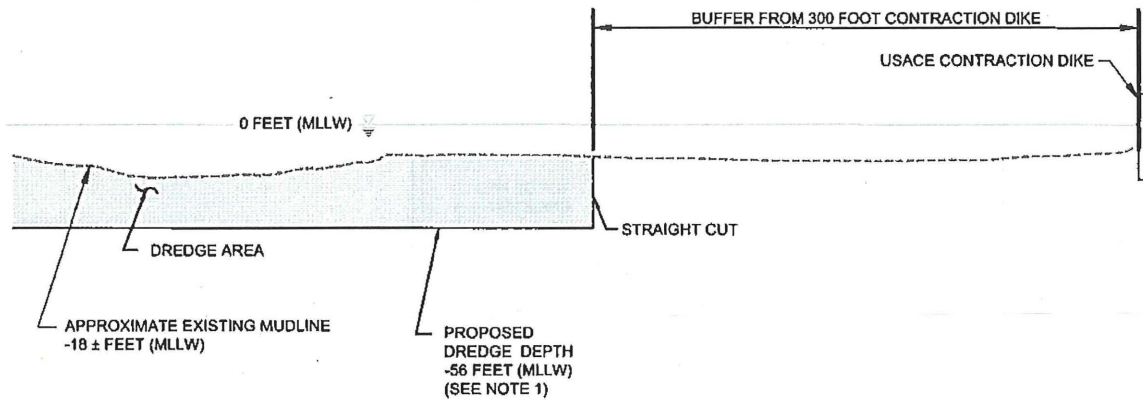

C-C SECTION - NORTH TRANSITION
6

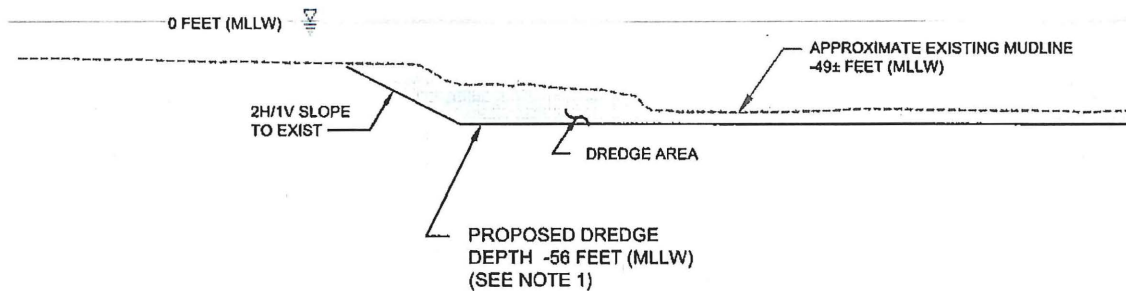

D-D SECTION - SOUTH TRANSITION
6

NOTES:

- 1 ACCESS AREA DREDGE DEPTH ENTAILS DREDGING TO EL. -52 FEET MLLW, PLUS 2 FEET ADVANCED MAINTENANCE DREDGING, PLUS 2 FEET ALLOWABLE OVERDREDGE.

REFERENCE:

- BATHYMETRIC CONTOURS SHOWN REFERENCE MULTIPLE SURVEYS FROM JULY 10, 2017, NOVEMBER 29, 2018, AND MARCH 31, 2015
- SITE PLAN FROM SOUTH CAROLINA PORTS AUTHORITY NEW CONTAINER TERMINAL PLAN JANUARY 22, 2003

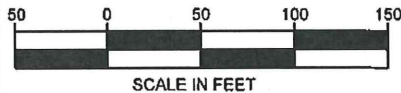

PROPOSED DREDGE AREA

VERTICAL DATUM: MLLW (FEET)
0 FEET (MLLW) = -3.18 FEET (NAVD88)
COORDINATE SYSTEM: S.C. STATE PLANE
(NAD83 in US FEET)

P/N # -

**PROPOSED CONDITIONS
PROFILE VIEW**
SOUTH CAROLINA PORTS AUTHORITY
176 CONCORD STREET
P.O. BOX 22287
CHARLESTON, S.C. 29413-2287

PROPOSED: HUGH K. LEATHERMAN, SR.
TERMINAL BERTH AND ACCESS DREDGING
AND REVETMENT MODIFICATION
IN: NORTH CHARLESTON
AT: CHARLESTON COUNTY, SOUTH CAROLINA
APPLICATION BY: SC PORTS AUTHORITY
SHEET: 8 OF 10 **DATE:** December 20, 2018

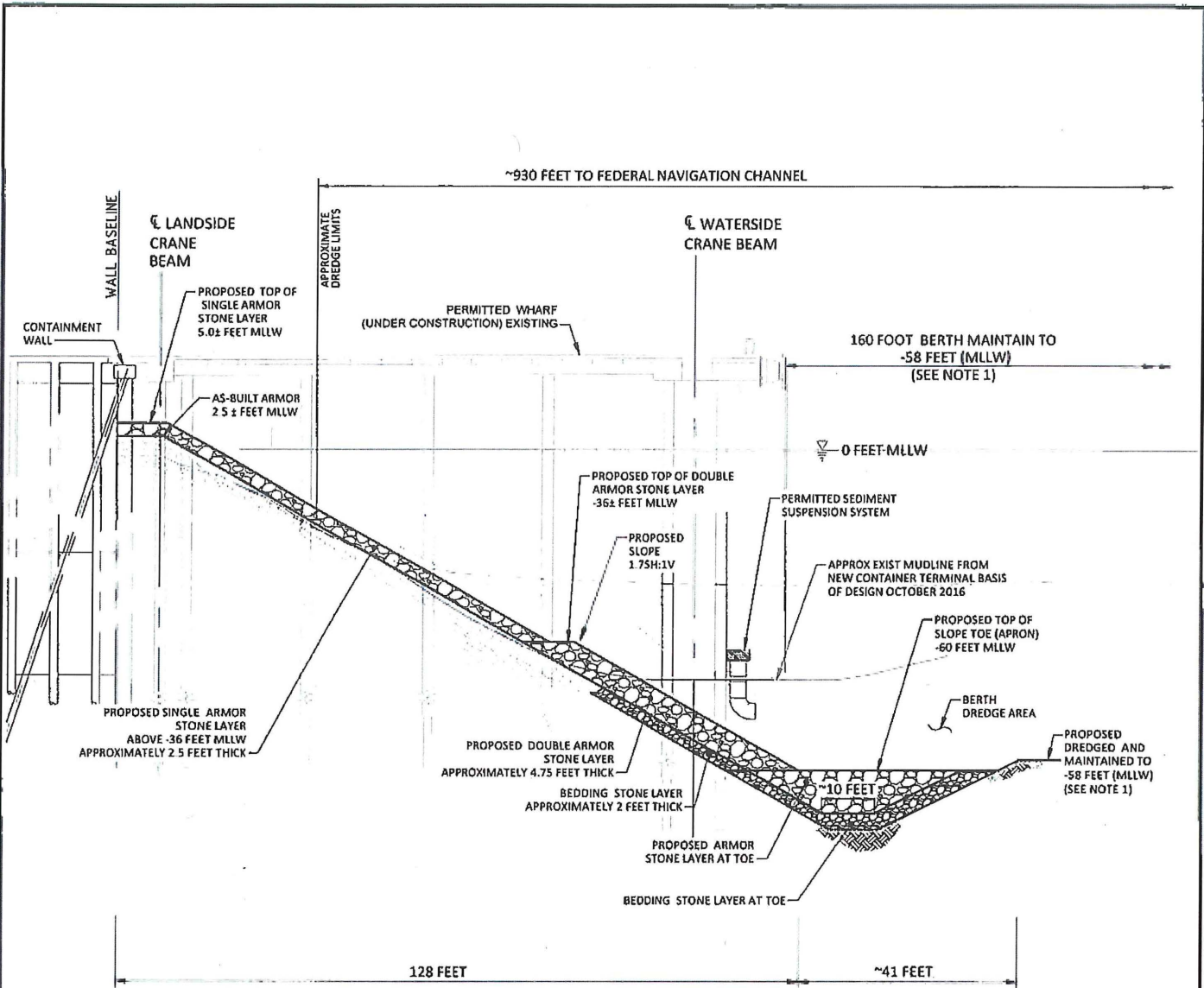

A
7 PROPOSED SLOPE PROTECTION TYPICAL SECTION
1.75V:1H SLOPE TOP OF SLOPE ALIGNED WITH TOP OF EXISTING REVETMENT

NOTE:

1. BERTH AREA DREDGE DEPTH ENTAILS DREDGING TO EL. -52 FEET MLLW, PLUS 2 FEET ADVANCED MAINTENANCE DREDGING, PLUS 2 FEET EXTREME LOW TIDAL VARIATION, PLUS 2 FEET ALLOWABLE OVERDREDGE

- PROPOSED DREDGE AREA
- PROPOSED ARMOR STONE LAYER
- PROPOSED BEDDING STONE LAYER
- EXISTING ARMAMENT (RIP-RAP) AREA (PER 2014 ASBUILT)

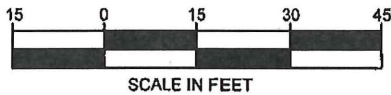
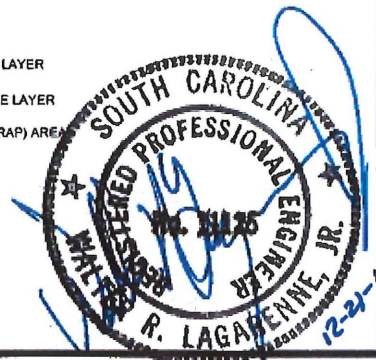

REFERENCE:
• BATHYMETRIC CONTOURS SHOWN REFERENCE MULTIPLE SURVEYS FROM JULY 10, 2017, NOVEMBER 29, 2016, AND MARCH 31, 2015

VERTICAL DATUM: MLLW (FEET)
0 FEET (MLLW) = -3.18 FEET (NAVD88)
COORDINATE SYSTEM: S.C. STATE PLANE
(NAD83 in US FEET)

P/N # -

PROPOSED SLOPE PROTECTION DETAIL

SOUTH CAROLINA PORTS AUTHORITY
176 CONCORD STREET
P.O. BOX 22287
CHARLESTON, S.C. 29413-2287

PROPOSED: HUGH K. LEATHERMAN, SR.
TERMINAL BERTH AND ACCESS DREDGING
AND REVETMENT MODIFICATION
IN: NORTH CHARLESTON
AT: CHARLESTON COUNTY, SOUTH CAROLINA
APPLICATION BY: SC PORTS AUTHORITY
SHEET: 9 OF 10 **DATE:** December 20, 2018

Name	State Plane X	State Plane Y
A	2384312.304	305185.821
B	2376741.168	291170.826
C	2391795.475	283067.786
D	2399371.043	297104.717
E	2384675.135	301659.432
F	2379495.145	291963.45
G	2390966.182	285797.391
H	2396237.184	295312.397

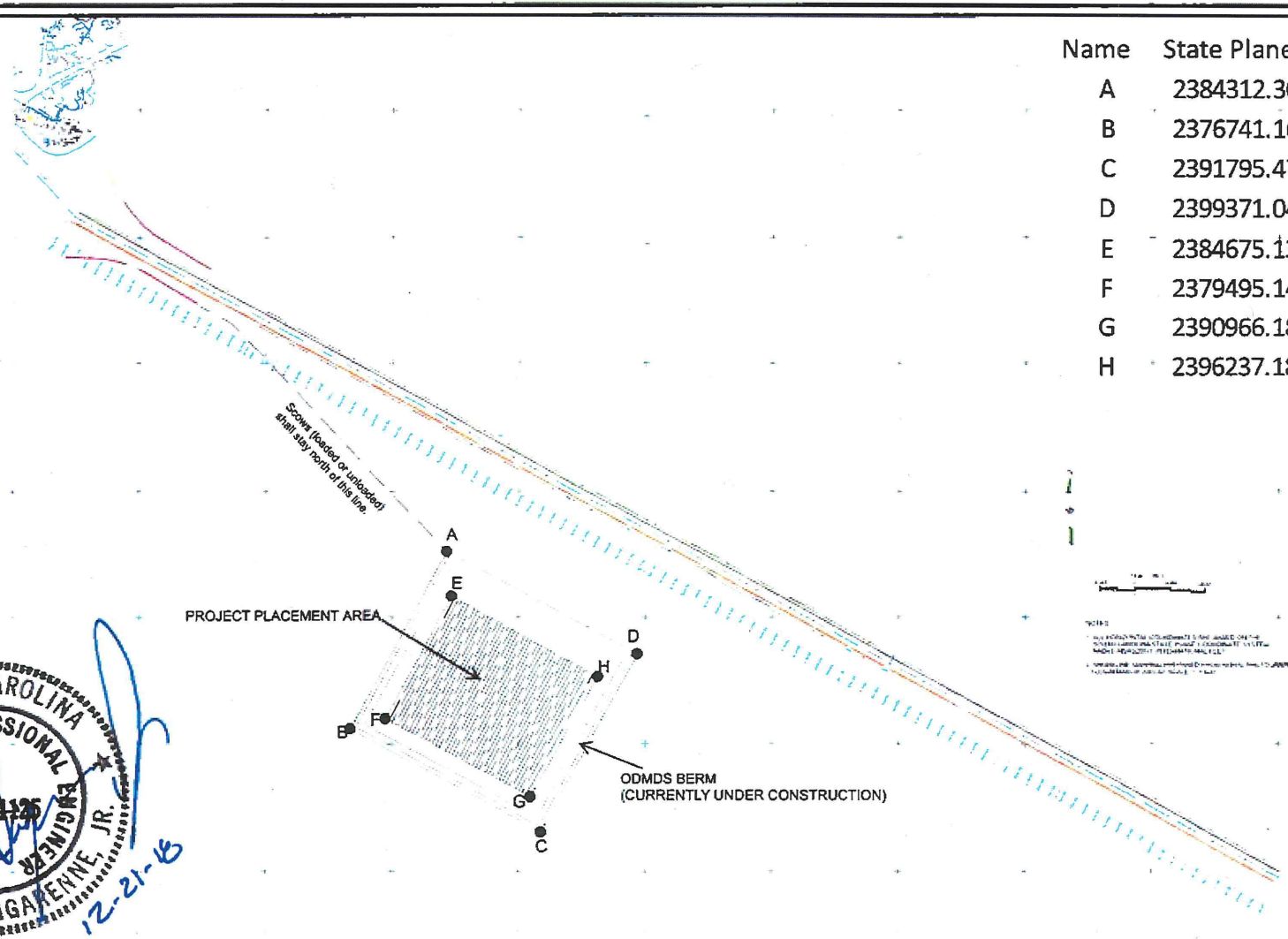

SOUTH CAROLINA
 REGISTERED PROFESSIONAL ENGINEER
 No. 11125
 WALTER R. LAGAYENNE, JR.
 12-21-18

VERTICAL DATUM: MLLW (FEET)
 0 FEET (MLLW) = -3.18 FEET (NAVD88)

COORDINATE SYSTEM: S.C. STATE PLANE (NAD83 in US FEET)

OCEAN DISPOSAL SITE LOCATION - CHARLESTON ODMDS

SOUTH CAROLINA PORTS AUTHORITY
 176 CONCORD STREET
 P.O. BOX 22287
 CHARLESTON, S.C. 29413-2187

PROPOSED: HUGH K. LEATHERMAN, SR. TERMINAL BERTH AND
 ACCESS DREDGING AND REVETMENT MODIFICATION
 IN: NORTH CHARLESTON
 AT: CHARLESTON COUNTY, SOUTH CAROLINA
 APPLICATION BY: SC PORTS AUTHORITY
 Sheet 10 of 10 Date: December 20, 2018